

Head-mounted central venous access during optical recordings and manipulations of neural activity in mice

In the format provided by the authors and unedited

4

3

2

1

D

D

C

C

B

B

A

A

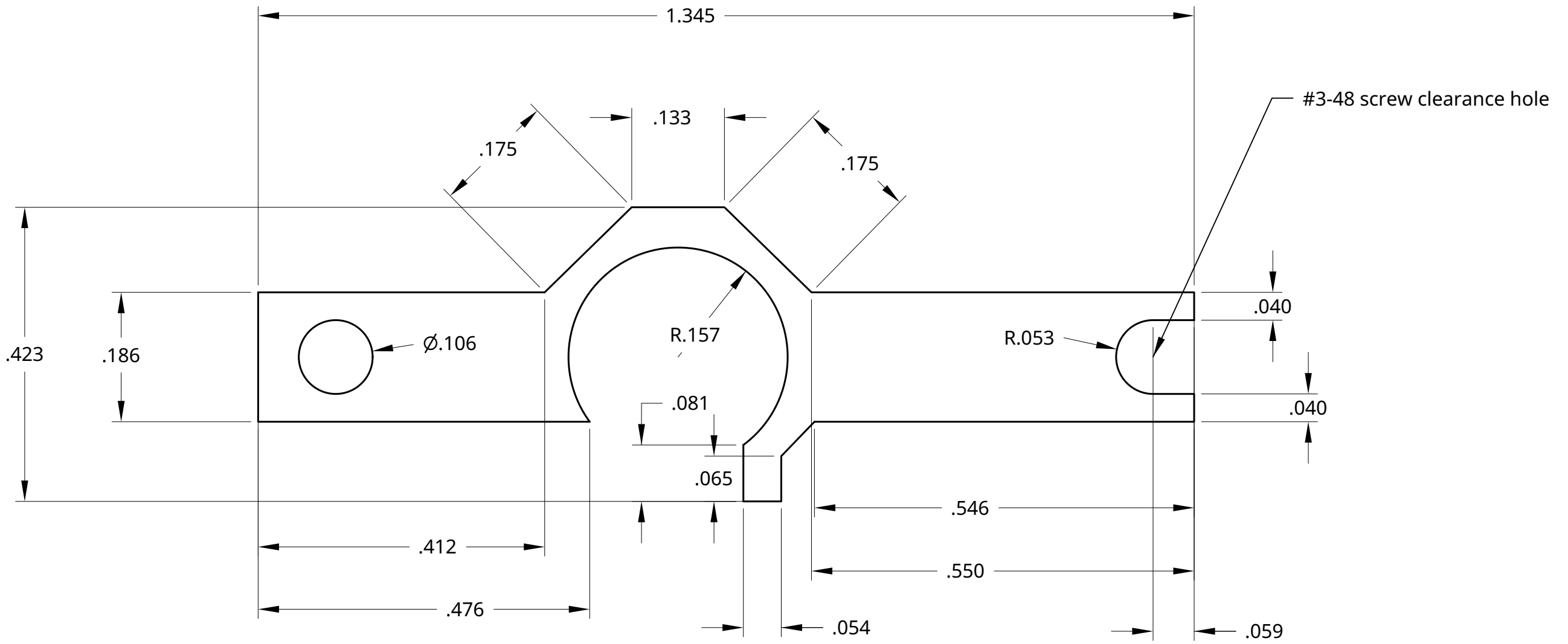

All measurements in inches
 Part cut from sheet metal
 Aluminum 6061
 Thickness = 0.031"

UNLESS OTHERWISE SPECIFIED,
 DIMENSIONS ARE IN INCHES

.XX = ±.0- ANGULAR = ± °
 .XXX = ±.00- FRACTIONAL = ±
 .XXXX = ±.000-

SURFACE FINISH

DO NOT SCALE DRAWING

BREAK ALL SHARP EDGES AND
 REMOVE BURRS

THIRD ANGLE PROJECTION

TITLE			
Lammel_headplates			
SIZE	DWG NO.	REV.	
B			
SCALE	WEIGHT	SHEET	1 of 1
6:1			

4

3

2

1

Supplementary Figure 1. Specifications for headplate construction. Details for lightweight headplates with clearance for neural implants on the surface of the skull and extended wings for head-fixation.